

SHIFT MECHANISM REMOVAL/INSTALLATION

B3E051646010W01

1. Remove the following parts:

- (1) battery and battery tray
(See [BATTERY REMOVAL/INSTALLATION \[ZJ, Z6\]](#).)
(See [BATTERY REMOVAL/INSTALLATION \[LF\]](#).)
- (2) Center console
(See [CONSOLE REMOVAL/INSTALLATION](#).)
- (3) Heat insulator (Front)

2. Remove in the order indicated in the table.

3. Install in the reverse order of removal.

4. After installation, verify that the shift lever can be shifted smoothly into each position.

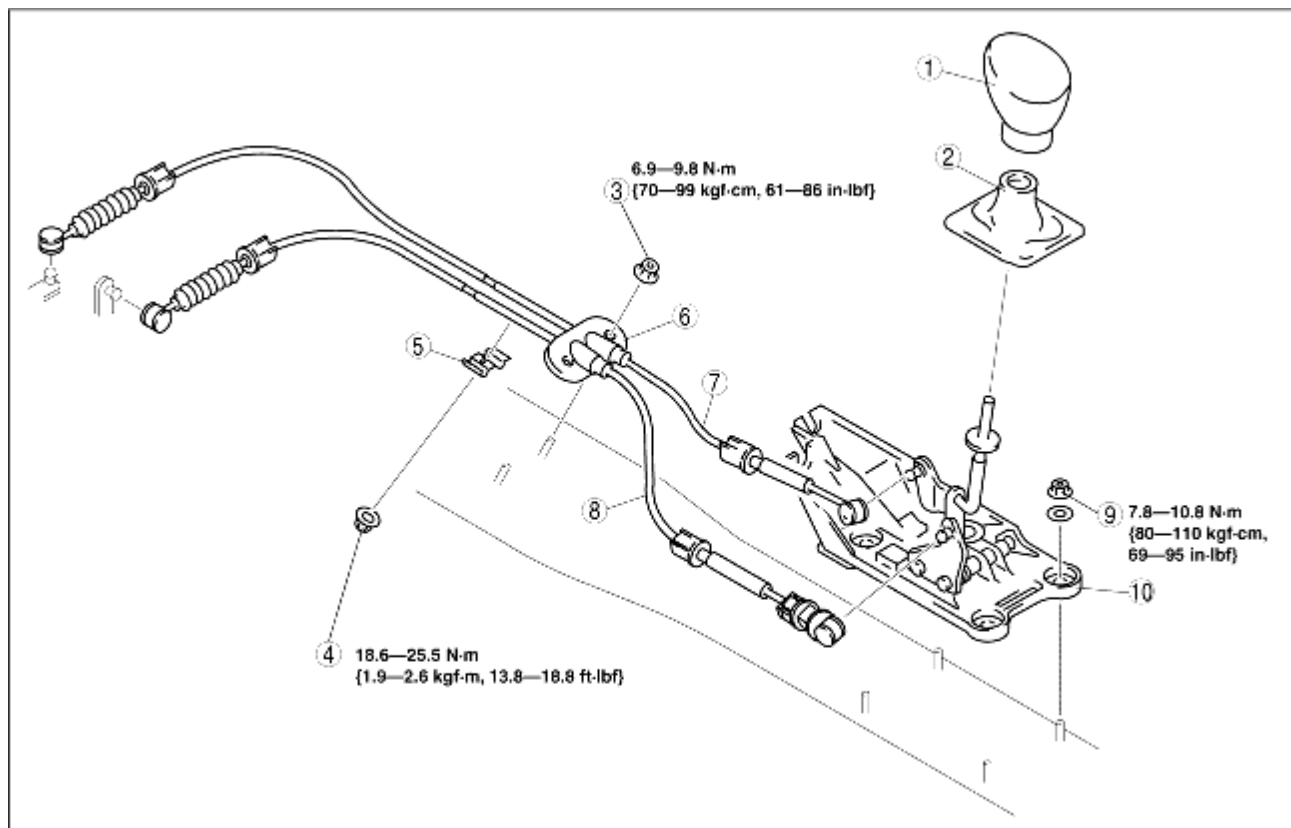

B3E0516W001

1	Shift lever knob
2	Boot panel
3	Nuts
4	Nut
5	Bracket
6	Seal plate

7	Main shift cable (See Main Shift Cable and Main Select Cable Removal Note.)
8	Main select cable (See Main Shift Cable and Main Select Cable Removal Note.) (See Select Cable Installation Note.)
9	Nuts
10	Shift lever component

Main Shift Cable and Main Select Cable Removal Note

1. Remove the both shift cable end and select cable end using a fastener remover.

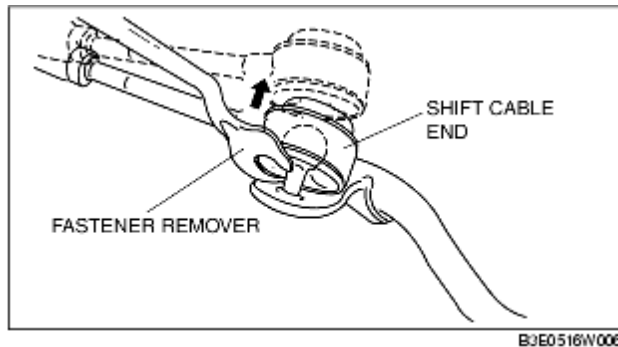

Select Cable Installation Note

1. Make sure that the shift lever (transaxle side) is in neutral.
2. Push the safety lock, then unlock the lock piece of the select cable in the order shown in the figure.

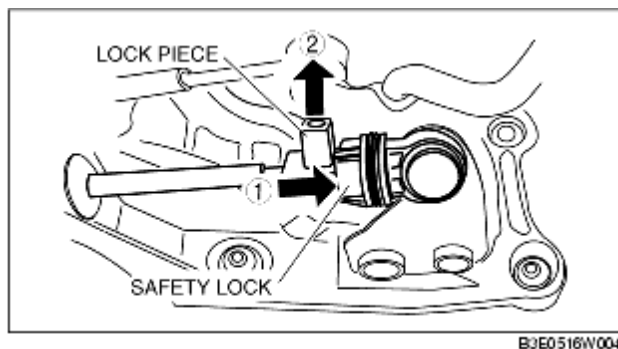

3. Shift the shift lever to neutral.
4. Lock the lock piece of the selector cable in the figure.

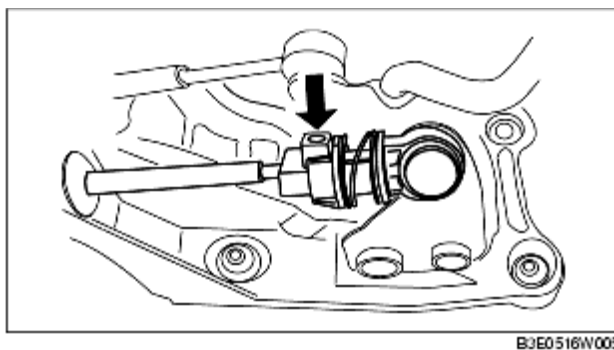

5. Shift the shift lever from neutral to other position, and make sure that there are no other components in that area to interfere with the lever.